

THEATER CHAIR SUMMARY

|            |     |
|------------|-----|
| 20" CHAIRS | 79  |
| 21" CHAIRS | 20  |
| 22" CHAIRS | 75  |
| TOTAL      | 274 |

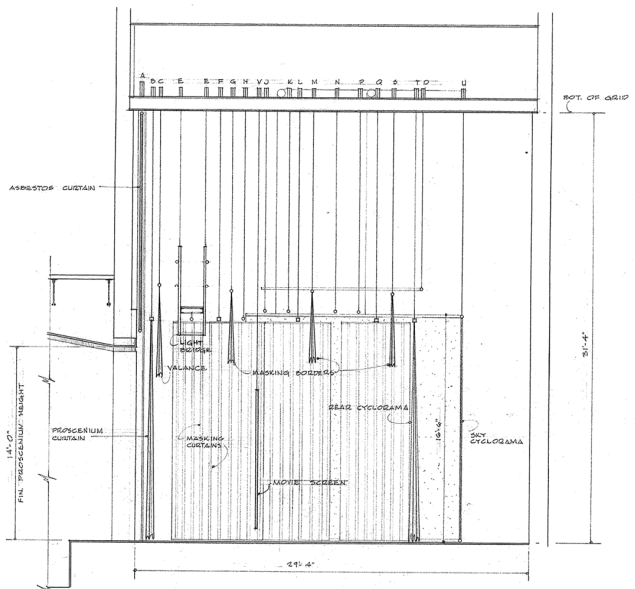

THEATER STAGE EQUIPMENT INDEX

|   |   |                                     |
|---|---|-------------------------------------|
| A | ASBESTOS CURTAIN                        | COUNTERWEIGHT SET ON STAGE RIGHT    |
| B | PROSCENIUM CURTAIN                      | COUNTERWEIGHT SET                   |
| C | VALANCE                                 | "                                   |
| D | SKY CYCLOGRAMA LIGHTING BATTEN          | "                                   |
| E | LIGHT BRIDGE                            | DOUBLE COUNTERWEIGHT SET WITH MORSE |
| F | FIRST SET MASKING CURTAINS (SIDE LEGS)  | COUNTERWEIGHT SET                   |
| G | FIRST MASKING BORDER                    | "                                   |
| H | SPACE                                   | "                                   |
| J | BORDELIGHT BATTEN                       | COUNTERWEIGHT SET                   |
| K | SPACE                                   | "                                   |
| L | SECOND SET MASKING CURTAINS (SIDE LEGS) | COUNTERWEIGHT SET                   |
| M | SECOND MASKING BORDER                   | "                                   |
| N | SPACE                                   | "                                   |
| P | BORDELIGHT BATTEN                       | COUNTERWEIGHT SET                   |
| Q | THIRD SET MASKING CURTAINS (SIDE LEGS)  | COUNTERWEIGHT SET                   |
| S | THIRD MASKING BORDER                    | COUNTERWEIGHT SET                   |
| T | SKY CYCLOGRAMA CURTAIN                  | COUNTERWEIGHT SET                   |
| U | SKY CYCLOGRAMA                          | COUNTERWEIGHT SET                   |
| V | MOVIE SCREEN                            | "                                   |

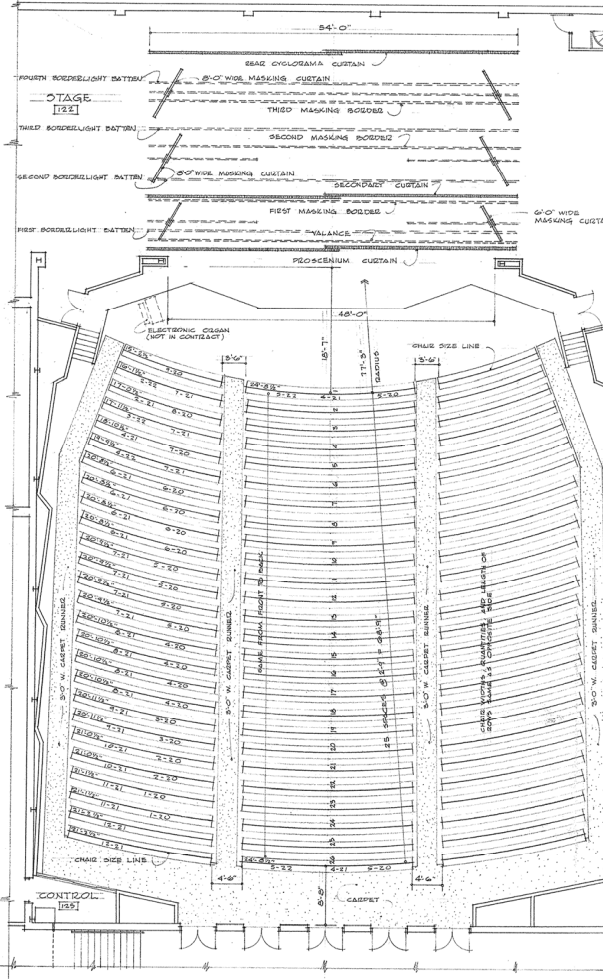
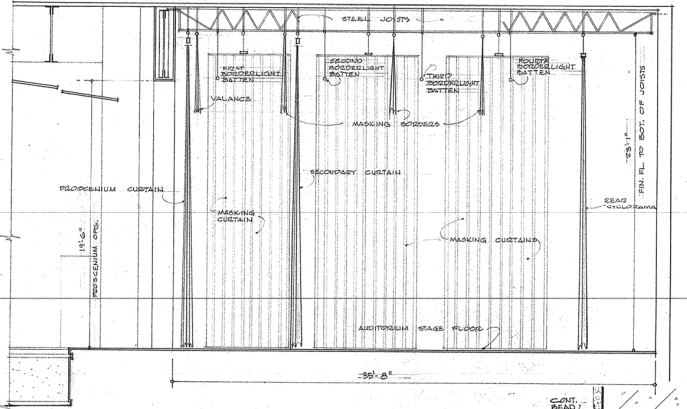

AUDITORIUM CHAIR SUMMARY

|            |     |
|------------|-----|
| 20" CHAIRS | 322 |
| 21" CHAIRS | 494 |
| 22" CHAIRS | 146 |
| TOTAL      | 962 |

ARTS-BUSINESS BUILDING  
KENTUCKY STATE COLLEGE  
FRANKFORT, KENTUCKY

STAGE EQUIPMENT SEATING PLAN 7-18

DESIGNED BY J. R. P.  
CHECKED BY J. L. B.REVISIONS

ARCHITECTS  
C. JULIAN OBERWARTH & ASSOCIATES  
323 SHELBY ST. FRANKFORT, KENTUCKY

COMMONWEALTH OF KENTUCKY  
DEPARTMENT OF FINANCE  
ENGINEERING STAFF  
FRANKFORT, KENTUCKY

APPROVED: *Carl W. Hill* DATE: 5/1/51  
APPROVED: *David H. Pritchett* DATE: 5/1/51

